

# LIVE CENTERS

For Accurate Work Holding in Conventional or CNC Lathes

## ROBUST, SAFE, PRECISION GUARANTEED!

### Standard Point

#### Model N

For a wide range of general turning work

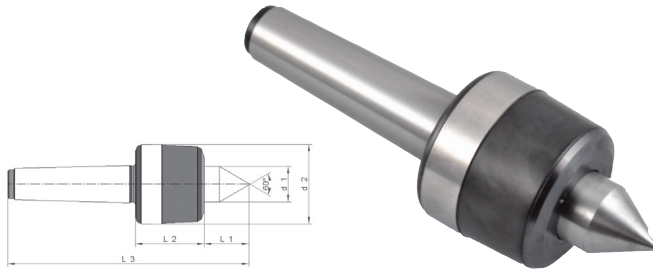

EDP Number	Part Number	Morse Taper	Load Factor lbs	Ø 1	Ø 2	Ø 3	Dimensions (Inch)			Price
							L1	L2	L3	
<b>Model N</b>										
LGN200B	R-200-N	2	400	0.709	1.654	--	0.945	1.378	5.039	<b>\$275</b>
LGN300B	R-300-N	3	890	0.866	1.929	--	1.142	1.850	6.417	<b>\$335</b>
LGN400B	R-400-N	4	1,765	1.181	2.480	--	1.378	2.047	7.717	<b>\$425</b>
LGN500B	R-500-N	5	3,860	1.299	3.346	--	1.890	2.520	9.843	<b>\$620</b>
<b>Model C</b>										
LGC300B	R-300-C	3	890	0.866	1.929	0.394	1.496	1.850	6.850	<b>\$380</b>
LGC400B	R-400-C	4	1,765	1.181	2.480	0.433	1.811	2.047	8.150	<b>\$485</b>
LGC500B	R-500-C	5	3,860	1.299	3.346	0.709	2.520	2.520	10.472	<b>\$686</b>

### Extended Point

#### Model C

Increases tool clearance and operator visibility for work on small parts or machining close to workpiece end



- ▶ Fully hardened and precision ground
- ▶ Maintenance free
- ▶ High precision with a maximum run-out of **0.00012"** for Morse tapers no. 2, 3, 4 and **0.00016"** for Morse Taper no. 5
- ▶ Capable of bearing workloads up to **2,200 lbs** and speeds up to **5,000 rpm**



**CALL TODAY**  
 for a complete catalog!  
**740-392-1549**

**World's Most Complete  
 Drill Chuck Offering**